

6

5

4

3

2

1

MATERIAL AND FINISH

Insulator: Polycarbonate, UL-94V-0 rated
Contacts: Brass, Nickel plated

ELECTRICAL SPECIFICATIONS:

Current rating: 10 A
Voltage rating: 250 VAC
Insulation resistance: 100 Mohm min. at 500 VDC
Dielectric withstanding voltage: 2000 VAC for one minute

ORDERING CODE:

42R36-3 2 - 2 - 3
1 2 3

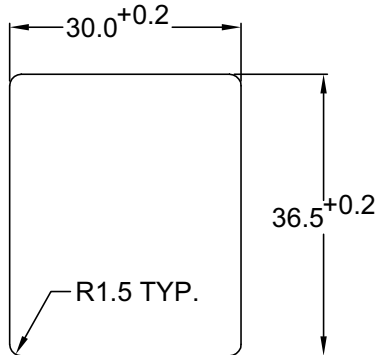

RECOMMENDED PANEL CUTOUT

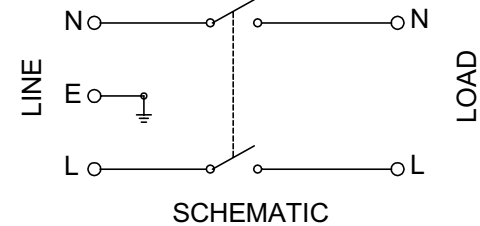
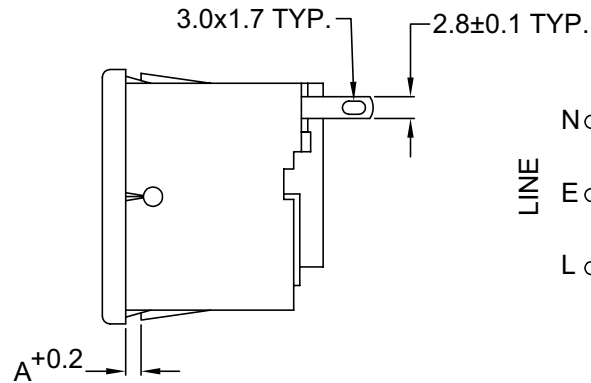

- 1) COLOR
1 = BLACK
2 = GRAY

2) ELECTRICAL CIRCUIT CONFIGURATION

2 = 10A 250V 70°C
2+GROUND
2 POLE SWITCH

4 = 10A 250V 120°C
2+GROUND
2 POLE SWITCH

6 = 10A 250V 70°C
2 POLE
2 POLE SWITCH

3) PANEL THICKNESS

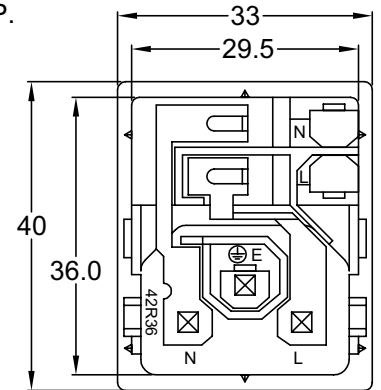
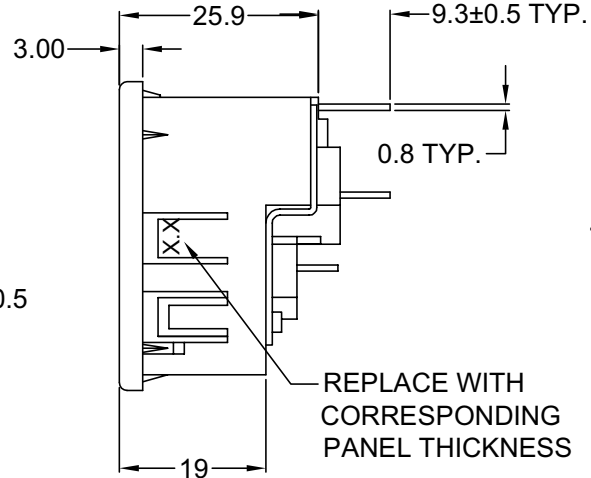
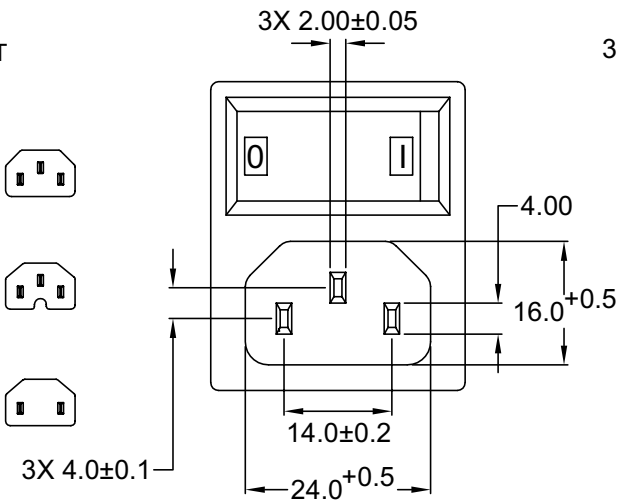

Distributed by Electro-Stock, Inc. sales@electrostock.com
630-682-1542 Fax 630-682-1562 http://www.electrostock.com

REV	DATE	CHANGE	CHNG	CHECK	APPR

P/N	A	MAX. PANEL THICKNESS
42R36-3X2X-150	1.5	1.5
42R36-3X2X-200	2.0	2.0

ADDITIONAL PANEL THICKNESS AND ONE POLE SWITCH AVAILABLE ON REQUEST

TOLERANCE UNLESS OTHERWISE SPECIFIED	
X	± 1
X.X	± 0.4
X.XX	± 0.20
DRAWN BY	GQ
DATE:	09/20/01
CHECK BY	TD
DATE:	09/21/01
APPR BY	PB
DATE:	09/21/01

Power Dynamics, Inc.

Phone: 973 560-0019 Whippany, New Jersey Fax: 973 560-0076

PART: IEC 60320 POWER SWITCH APPL. INLET;
SOLDER TERMINALS; SNAP-IN

PART #: 42R36-3X2X-XXX		SHEET 1 of 1
SIZE: A	ALL DIMENSIONS FOR REFERENCE ONLY DIMENSIONS ARE IN MILLIMETERS	REV:
SCALE: NTS		

6

5

4

3

2

1

6 5 4 3 2 1

MATERIAL AND FINISH

Insulator: Polycarbonate, UL-94V-0 rated
 Contacts: Brass, Nickel plated

ELECTRICAL SPECIFICATIONS:

Current rating: 10 A
 Voltage rating: 250 VAC
 Insulation resistance: 100 Mohm min. at 500 VDC
 Dielectric withstanding voltage: 2000 VAC for one minute

ORDERING CODE:

42R36-3 $\frac{5}{1 \quad 2 \quad 3}$

RECOMMENDED
 PANEL CUTOUT

1) COLOR
 1 = BLACK
 2 = GRAY

2) ELECTRICAL CIRCUIT CONFIGURATION

2 = 10A 250V 70°C
 2+GROUND
 2 POLE SWITCH

4 = 10A 250V 120°C
 2+GROUND
 2 POLE SWITCH

6 = 10A 250V 120°C
 2 POLE
 2 POLE SWITCH

3) PANEL THICKNESS

Distributed by Electro-Stock, Inc. sales@electrostock.com
 630-682-1542 Fax 630-682-1562 http://www.electrostock.com

P/N	A	MAX. PANEL THICKNESS
42R36-3X5X-150	1.5	1.5
42R36-3X5X-200	2.0	2.0

ADDITIONAL PANEL THICKNESS, ONE POLE SWITCH,
 AND .187 QC TERMINALS AVAILABLE ON REQUEST

TOLERANCE UNLESS OTHERWISE SPECIFIED	
X	± 1
X.X	± 0.4
X.XX	± 0.20

DRAWN BY	GQ	DATE:	09/20/01
CHECK BY	TD	DATE:	09/21/01
APPR BY	PB	DATE:	09/21/01

Power Dynamics, Inc.
 Phone: 973 560-0019 Whippany, New Jersey Fax: 973 560-0076

PART: IEC 60320 POWER SWITCH APPL. INLET;
 QC TERMINALS; SNAP-IN

42R36-3X5X-XXX

SIZE: A
 SCALE: NTS

ALL DIMENSIONS FOR REFERENCE ONLY
 DIMENSIONS ARE IN MILLIMETERS

SHEET 1 of 1
 REV:

REVISIONS
 CHANGE
 CHNG CHECK APPR
 REV DATE

6 5 4 3 2 1