

6

5

4

3

2

1

MATERIAL AND FINISH

Insulator: PC (Polycarbonate), color black, UL-94V-0 rated
Contacts: Brass, Tin Plated

ELECTRICAL SPECIFICATIONS:

Current rating: 10 A
Voltage rating: 250 VAC
Current rating: 15 A
Voltage rating: 250 VAC

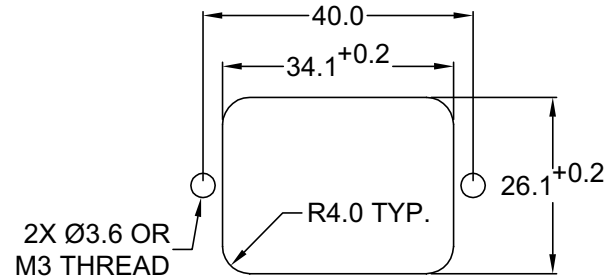
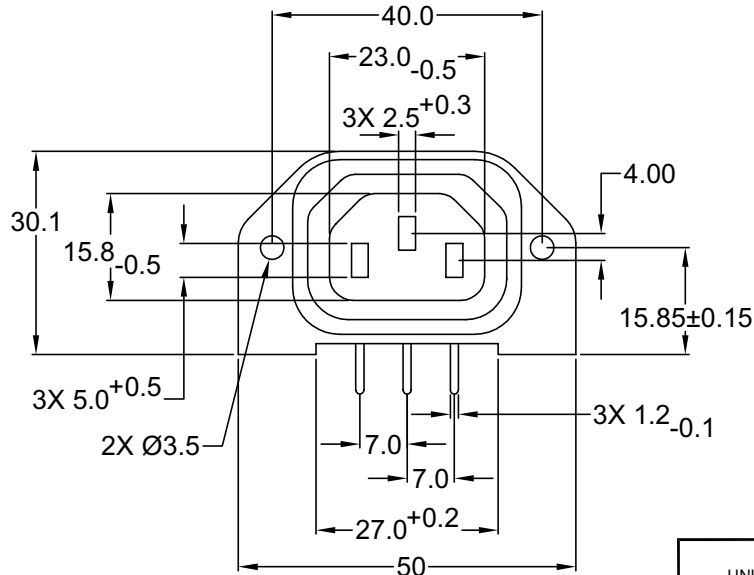
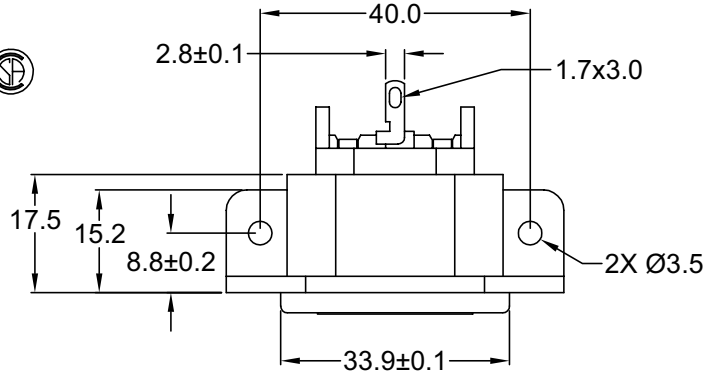

RECOMMENDED PANEL CUTOUT

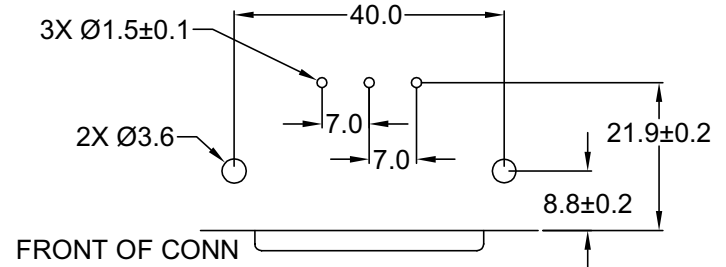

RECOMMENDED PCB LAYOUT (TOP VIEW)

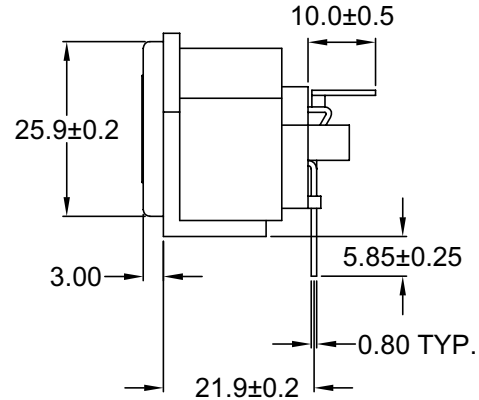

Distributed by Electro-Stock, Inc. sales@electrostock.com
630-682-1542 Fax 630-682-1562 http://www.electrostock.com

TOLERANCE UNLESS OTHERWISE SPECIFIED	
X	± 1
X.X	± 0.4
X.XX	± 0.20
DRAWN BY	AH
CHECK BY	
APPR BY	SS
DATE:	3/25/98
DATE:	
DATE:	11/9/98

Power Dynamics, Inc.

Phone: 973 560-0019 Whippany, New Jersey Fax: 973 560-0076

PART: IEC 60320 C13 APPL. OUTLET; PCB
TERMINALS, SIDE FLANGE

PART #: **43R65**

SIZE: A
SCALE: NTS

ALL DIMENSIONS FOR REFERENCE ONLY
DIMENSIONS ARE IN MILLIMETERS

SHEET
1 of 1

REV: A

D

C

B

A

6

5

4

3

2

1

REVISIONS

REV	DATE	CHANGE	CHNG	CHK	APPR
A	12/05/01	REVISED / UPDATED	GQ	TD	PB